

Year 6

Rush Common School

2022-2023

Miss Walton and Mrs Neal

Mrs Atyeo



Meet the Teachers and TAs:

- ▶ The Teachers in Year 6 this year are Miss Walton and Mrs Neal.
- ▶ Our Teaching Assistant is Mrs Atyeo.



School Uniform:

- ▶ Regular school uniform is expected to be worn everyday. On the day that your child has PE, they should wear PE kit.
- ▶ Please refer to the school uniform policy on the website.

Additional reminders:

- ▶ Hair should be tied back using a scrunchie, hair band, clip or ribbon that is black, brown or green.
- ▶ Hair gel should not be used to style hair.
- ▶ No extreme hairstyles please - unnatural colours, shaved styles
- ▶ Minimal jewellery should be worn for practical, health and safety reasons.
- ▶ A wristwatch and/or single stud earring in each ear lobe are permitted.
- ▶ All jewellery should be removed for PE and games.
- ▶ Nail varnish and make-up are not permitted.



Mobile phones (Y5 & Y6):

- ▶ Permission should be sought from Mr Fawcett.
- ▶ They must be handed into the class teacher at the start of the day and will be kept in a secure area.
- ▶ They are returned at the end of the day but must not be switched on until the child has left the school grounds.



Communication:

- ▶ Please ensure that any communication with teachers is sent through the school office email.
- ▶ Weekly updates for your year group will be sent out to update you on what your child has been learning in school that week as well as what they will be learning in the upcoming week.
- ▶ Weekly Updates will also share important dates and reminders throughout the year.
- ▶ There is a fortnightly newsletter for all parents.



Communication

- ▶ Year group updates will be sent out weekly via the My Child at School app (BromCom).
- ▶ In the case of families with children in multiple year groups, you must select an individual child to view their year group update.
 - ▶ Select the three bars in the top left corner.
 - ▶ From the drop down menu, select your child.
 - ▶ Click on the megaphone icon at the bottom of the app.
- ▶ School-wide updates (i.e. Sports Day, Photo Day, etc.) will be sent via ParentMail.

ParentMail will continue to be our method for payments as well (i.e. trips, lunches)

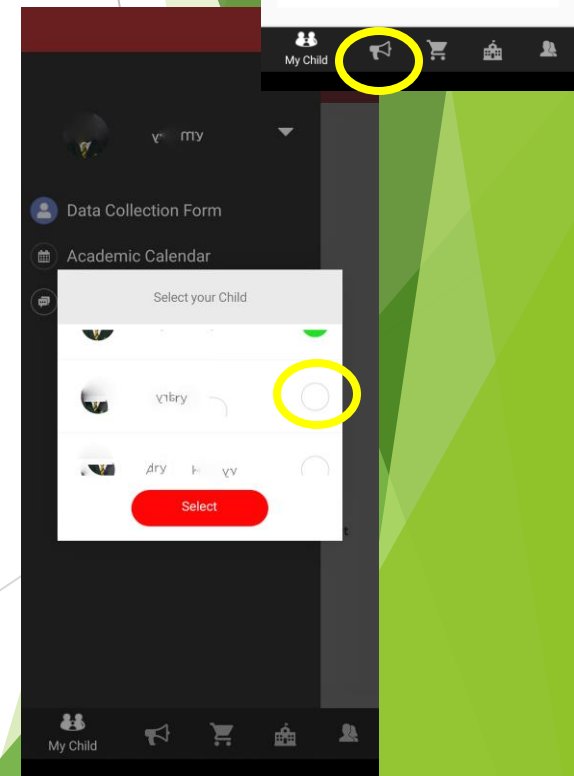
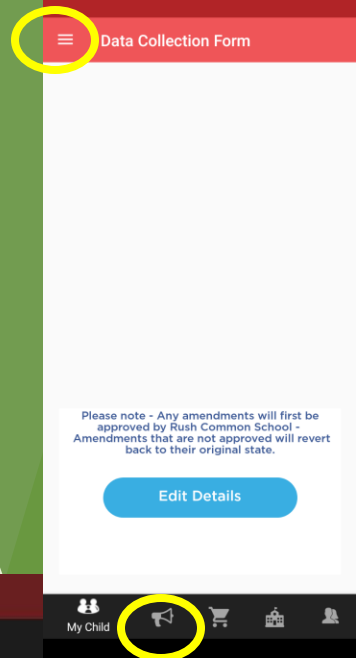

	<u>8.30-9.00</u>	<u>9.00-9.30</u>	<u>9.30-10.30</u>	<u>10.30-10.55</u>	<u>10.55-12.00</u>	<u>12.00-1.00</u>	<u>1.00-2.00</u>	<u>2.00 -3.00</u>	
MONDAY	Arithmetic/RfP	Reading	English	Break	Maths	Lunch – Reflection	PSHE 1.00-1.40pm	PE 1.40pm-2.30pm	Assembly 2.30 pm
TUESDAY	Arithmetic/RfP	Reading	English	Break	Maths	Lunch – Reflection	Science		R.E
WEDNESDAY	Spelling test and homework marking	Reading	English	Break	Maths	Lunch – Reflection	Library 1.00 pm (15 mins)	Humanities	
THURSDAY Y6 PPA pm	Handwriting/ Spellings	Reading	English	Break	Maths	Lunch – Reflection	6JN Music/Mandarin (alternate weeks): 1.00 – 2.00 pm 6JN PE: 2.00-2.55pm 6EW PE: 1.00-2.00pm 6EW Music/Mandarin (alternate weeks): 2.00 – 3.00 pm		
FRIDAY	Arithmetic	RfP	English	Break	Maths	Lunch – Reflection	Rfp	Computing Art (alternate weeks)	Assembly 2.30 pm

Lunch arrangements:

- ▶ School meals are available to order through ParentMail.
- ▶ School dinners for KS2 are £2.20.
- ▶ Reception eat at 11:45; Y1-Y2 eat at 12:00; Y3-Y6 eat at 12:30.
- ▶ YR - Y2 have playtime at 12:30; Y3-Y6 have playtime at 12:00.



Curriculum Information:

- ▶ Indoor P.E will take place on a Monday afternoon and Outdoor P.E will take place on a Thursday afternoon.
- ▶ Our topic for this term will be World War II.
- ▶ Mandarin and Music lessons will be taught on alternate Thursday afternoons by Yin Lao Shao and Mrs Wallis.



Curriculum and enrichment:

- ▶ STEAM museum (approx. £20) **Parent helpers if available**
- ▶ Swimming (after Christmas - exact dates TBC. approx. £22)
- ▶ Carol Concert at St Helen's church - December
- ▶ World Book Day - Thursday 2nd March
- ▶ Junior Citizens (Summer term)
- ▶ Call Of The Wild (26th - 30th June. Approx £399)
- ▶ Y6 Production (Summer term)



Please refer to the school calendar on the website for any other key dates for the year.

Dates for Swimming:

▶ 6JN

January - 9th, 16th, 23rd, 30th

February - 6th, 20th

▶ 6EW

February - 27th

March - 6th, 13th, 20th, 27th

April - 17th

Curriculum and teaching methods:

- ▶ New teaching methods that will introduced in Year 6:

Long Division

[youtube.com/watch?reload=9&v=LGqBQrUYua4](https://www.youtube.com/watch?reload=9&v=LGqBQrUYua4) (by one digit)

https://www.youtube.com/watch?v=HdU_rf7eMTI (by 2 digits)



SATs

- ▶ SATs week will be week commencing 8th May 2022.
- ▶ An information evening will be held prior to SATs week.
- ▶ Children will complete:
 - Reading paper x 1
 - Spelling, punctuation and grammar (SPaG) paper
 - Maths papers x3 (Arithmetic, Reasoning 1 and Reasoning 2)

During this week, we will provide Year 6 children with a breakfast as well as biscuits and squash.

Other ways to support your child:

- ▶ Daily reading - listen to your child read, but also read to them. Fluency, decoding and comprehension are key components with supporting and developing reading skills.
- ▶ Talking about current events, plans, what you or they are reading. This will help build their vocabulary.
- ▶ Practise spellings.
- ▶ Practise Maths - mental maths, times tables, adding, baking, shopping, etc.



Google Classroom:

- ▶ Your child's account will be set up in their new class.
- ▶ Please ensure that you are able to access Google Classroom through your devices at home.
- ▶ Google Classroom may be used by year groups for some homework.



Homework expectations:

- ▶ Homework menu
- ▶ Spelling lists: Spellings tested every Wednesday.
- ▶ Daily reading and Times Tables practise.
- ▶ Three Maths tasks per half term.
- ▶ Three Reading Comprehension tasks per half term.
- ▶ Homework Books will be provided for all children.
- ▶ Most homework tasks will be completed in books.



How you can support the school:

- ▶ Support social and fundraising events.
- ▶ Join Friends of Rush Common (FoRC).
- ▶ Become a Governor.
- ▶ Volunteering your skills and talents - gardening, crafts, resources.
- ▶ Become a reading volunteer or help in forest school.



▶ Follow us on social media and share our news.

Behaviour:

Be Safe, Be Kind, Be Respectful

- ▶ Our behaviour management is based on a restorative approach.
- ▶ We create a positive environment throughout the school and model our three school rules.
- ▶ Recognition of positive behaviour through House Points, Celebration Nominations, Homework Champions and Sporting Champions.



Pupil Welfare:

- ▶ Keep the school up-to-date on any medical conditions. We will need to see a letter from a medical professional.
- ▶ Only prescription medication required more than 3 times daily can be administered. This will need to be signed in by a First Aider. Requests for any exceptions to this must be made to Mr Fawcett.
- ▶ It is parents' and carers' responsibility to ensure medication/inhalers are in date.
- ▶ Please ensure that you child/ren are equipped appropriately for the weather. (i.e. sunscreen/hats in summer, coats in winter and raincoats as necessary).



Please communicate any significant bumps or injuries to class teachers.

Pupil Welfare:

- ▶ **Bullying:**
when someone is deliberately hurtful to someone over a period of time.
 - ▶ **At school we:**
 - ▶ have anti-bullying ambassadors
 - ▶ raise awareness through assemblies, presentations, forums, nurture groups, PSHE lessons and pupil leadership.
- ▶ **Online Safety:**
 - ▶ We have regular lessons for pupils throughout the school year.
 - ▶ Follow SMART rules (Safe, Meeting, Accepting, Reliable, Tell) - <https://www.childnet.com/resources/be-smart-online>
 - ▶ **At home:**
 - ▶ Ensure the content they access is age-appropriate.
 - ▶ Set rules and boundaries together.
 - ▶ Don't ban the internet outright. Have an open conversation about it.
 - ▶ Train your child to know what to do if something makes them uncomfortable. Show them the tools to use to report abuse.
 - ▶ Visit <https://www.thinkuknow.co.uk/>.



Questions?

