

Year 5

Rush Common School

2022 - 2023

Mrs Carr

Miss Smith

Mrs Clear

Mrs Furlonger



Meet the Teachers and TAs:

- ▶ Mrs Carr will be teaching in 5EC.
- ▶ Miss Smith will be teaching in 5AS.

- ▶ Mrs Clear will support across both classes in the mornings and work with children in intervention groups in the afternoons.
- ▶ Mrs Furlonger will also be spending some time supporting in 5EC.

- ▶ Mrs Kendry, Mrs Yin and Mrs Wallis will be teaching Computing, Mandarin and Music on Thursday afternoons.
- ▶ Mrs Wallis will be teaching on Friday afternoons in 5AS.



School Uniform:

- ▶ Regular school uniform is expected to be worn everyday. On the days that your child has PE, they should wear PE kit. In Year 5, these are **Tuesdays** and **Wednesdays**.
- ▶ Please refer to the school uniform policy on the website.

Additional reminders:

- ▶ Long hair should be tied back using a scrunchie, hair band, clip or ribbon that is black, brown or green.
- ▶ Hair gel should not be used to style hair.
- ▶ No extreme hairstyles please - unnatural colours, shaved styles, etc.
- ▶ Minimal jewellery should be worn for practical, health and safety reasons.
- ▶ A wristwatch and/or single stud earring in each ear lobe are permitted.
- ▶ All jewellery should be removed for PE and games.
- ▶ Nail varnish and make-up are not permitted.



Mobile phones (Y5 & Y6):

- ▶ Permission should be sought from Mr Fawcett.
- ▶ They must be handed into the class teacher at the start of the day and will be kept in a secure area.
- ▶ They are returned at the end of the day but must not be switched on until the child has left the school grounds.



Communication:

- ▶ Please ensure that any communication with teachers is sent through the school office email.
- ▶ Weekly Updates for your year group will be sent out to update you on what your child has been learning in school that week as well as what they will be learning in the upcoming week. This will be through the My Child At School (MCAS) app.
- ▶ Weekly Updates will also share important dates and reminders throughout the year.
- ▶ There is a fortnightly newsletter for all parents.



The School Day:

	8:30 – 9:00	9:00 – 9:30	9:30 – 10:35	10:35 – 10:55	10:55 – 12:00	12:00 – 1:00	1:00 – 1:10	1:10 – 2:00	2:00 – 3:00	
MONDAY	TTRS Pink challenges/ respond to feedback	Reading	English	Break	Maths	Lunch	Handwriting	1-2.30 Science		Values Assembly
TUESDAY	Spelling Test	Reading	English	Break	Maths	Lunch	Handwriting	PE (indoor)	Art	
WEDNESDAY	TTRS Pink challenges/ respond to feedback	Reading	English	Break	Maths	Lunch	Handwriting	PE (outdoor)	RE	Library
THURSDAY	TTRS Pink challenges/ respond to feedback	Reading	English	Break	Maths	Lunch	Handwriting	PPA Mandarin Music Computing		
FRIDAY	TTRS Pink challenges/ respond to feedback	Reading for Pleasure	English	Break	Maths	Lunch	Handwriting	Humanities	PSHE	Celebration Assembly

Lunch arrangements:

- ▶ School meals are available to order through ParentMail.
- ▶ School dinners for KS2 are £2.20.
- ▶ Reception eat at 11:45; Y1-Y2 eat at 12:00; Y3-Y6 eat at 12:30.
- ▶ YR - Y2 have playtime at 12:30; Y3-Y6 have playtime at 12:00.



Curriculum:

Reading- Cogheart

English- Setting descriptions, letter writing, brochures, information reports and poetry

Maths- Place value, four operations, statistics, perimeter and area

Science- Properties of materials and forces

Humanities- The Victorians

PE- Cross country and circuits

Mandarin- Phone conversations

Art and DT- William Morris and Victorian toys

RE- Rituals, pilgrimage and art in Christianity and Islam

PSHE- Being me in the world and celebrating differences

Music- Describing musical elements in Victorian music

Computing- Typing skills and online safety



Curriculum and enrichment:

- ▶ Victorians trip to the Oxfordshire Museum, Woodstock in November.
- ▶ Space Day in April (provisional).
- ▶ Bikeability in Term 2b. More details will be provided during Term 2.
- ▶ Residential to Wolverhampton- this will take place in term 3b. Information about the residential will be sent out to you soon.
- ▶ Whole school events such as World Book Day in March, Scholastic Book Fair in October and Anti-Bullying Week in November.



Curriculum and teaching methods:

- ▶ Look, cover, write check is a common strategy used to practise spellings each week. Other strategies such as pyramid words, writing a word backwards and in different writing styles provides variation when practising spelling.

Pyramid Writing

Write each of your words
like a pyramid:

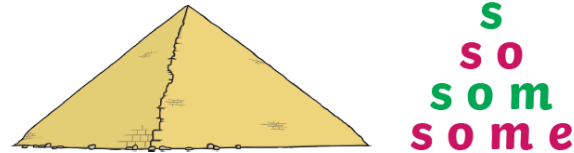

- ▶ As part of our writing curriculum we follow a 3 stage process of immersion, practise and application. We'd encourage you to reflect with your children on the areas that they would like to improve on in the next stage of their writing.

Please also refer to the calculation policy on the school website.



Other ways to support your child:

- ▶ Daily reading - listen to your child read, but also read to them.
- ▶ Conversation - talking about current events, plans, what you or they are reading. This will help build their vocabulary.
- ▶ Practise Maths - mental maths, times tables, adding, baking, shopping, etc.



Google Classroom:

- ▶ Your child's account will be set up in their new class.
- ▶ Please ensure that you are able to access Google Classroom through your devices at home.
- ▶ Google Classroom may be used for some homework.



Homework expectations:

- ▶ Takeaway menu: 6 per big term
- ▶ Spelling lists: 1 per week. Spelling tests will be on Tuesdays. These will be done in the back of their Homework books.
- ▶ Reading for pleasure
- ▶ Times tables: these will be completed 4 times a week and stuck into the back of homework books.
- ▶ Homework books will be provided for all children.
- ▶ Each week there will either: reading comprehension or maths activity.
- ▶ On occasion we may use Google Classroom to set homework at certain points in the year. We will however give you advance notice of this when using the platform.



How you can support the school:

- ▶ Support social and fundraising events.
- ▶ Join Friends of Rush Common (FoRC).
- ▶ Become a Governor.
- ▶ Volunteering your skills and talents - gardening, crafts, resources.
- ▶ Become a reading volunteer or help in forest school.



▶ Follow us on social media and share our news.

Behaviour:

Be Safe, Be Kind, Be Respectful

- ▶ Our behaviour management is based on a restorative approach.
- ▶ We create a positive environment throughout the school and model our three school rules.
- ▶ Recognition of positive behaviour through House Points, Celebration Nominations, Homework Champions and Sporting Champions.



Pupil Welfare:

- ▶ Keep the school up-to-date on any medical conditions. We will need to see a letter from a medical professional.
- ▶ Only prescription medication required more than 3 times daily can be administered. This will need to be signed in by a First Aider. Requests for any exceptions to this must be made to Mr Fawcett.
- ▶ It is parents' and carers' responsibility to ensure medication/inhalers are in date.
- ▶ Please ensure that your child/ren are equipped appropriately for the weather. (i.e. sunscreen/hats in summer, coats in winter and raincoats as necessary).



Please communicate any significant bumps or injuries to class teachers.

Pupil Welfare:

- ▶ **Bullying:**
when someone is deliberately hurtful to someone over a period of time.
 - ▶ **At school we:**
 - ▶ have anti-bullying ambassadors
 - ▶ raise awareness through assemblies, presentations, forums, nurture groups, PSHE lessons and pupil leadership.
- ▶ **Online Safety:**
 - ▶ We have regular lessons for pupils throughout the school year.
 - ▶ Follow SMART rules (Safe, Meeting, Accepting, Reliable, Tell) - <https://www.childnet.com/resources/be-smart-online>
 - ▶ **At home:**
 - ▶ Ensure the content they access is age-appropriate.
 - ▶ Set rules and boundaries together.
 - ▶ Don't ban the internet outright. Have an open conversation about it.
 - ▶ Train your child to know what to do if something makes them uncomfortable. Show them the tools to use to report abuse.
 - ▶ Visit <https://www.thinkuknow.co.uk/>.



Communication

- ▶ Year group updates will be sent out weekly via the My Child at School app (BromCom).
- ▶ In the case of families with children in multiple year groups, you must select an individual child to view their year group update.
 - ▶ Select the three bars in the top left corner.
 - ▶ From the drop down menu, select your child.
 - ▶ Click on the megaphone icon at the bottom of the app.
- ▶ School-wide updates (i.e. Sports Day, Photo Day, etc.) will be sent via ParentMail.

ParentMail will continue to be our method for payments as well (i.e. trips, lunches)

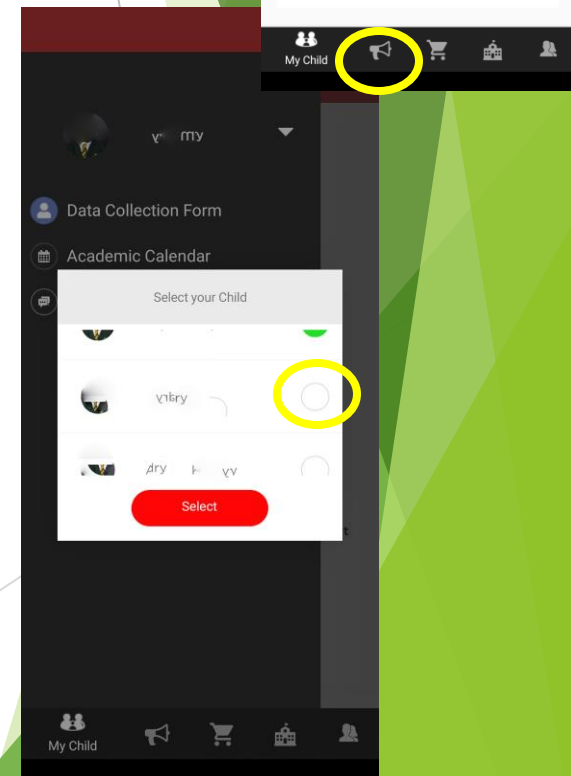
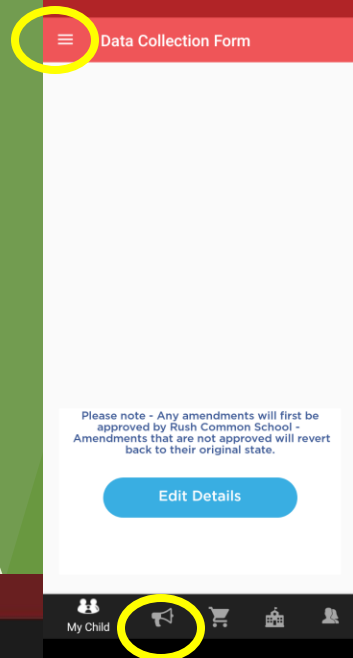

Questions?

